

FLEXTREM premium full rubber hose

Premium, full rubber hose (silicone-free) with high-tech weaving. The BluBird and the Oilshield hose combine innovative materials, aiming to achieve genuine low-temperature flexibility, exceptional oil resistance and durability. They offer the premium characteristics of high-end rubber hoses, combined with a weight reduction of more than 40% compared to other similar hoses. Its manoeuvrability is commonly related only to hybrid hoses. With these outstanding properties the FLEXTREM hoses are ideal for automotive and industrial applications, indoors and outdoors.

FLEXTREM BluBird

- Extremely lightweight: only 145–155 g per m at 10 mm inner diameter
- Extremely flexible at temperatures from -50 °C up to +90 °C
- Extremely durable with ozone-resistant rubber compound for protection against extreme weather conditions
- Extremely robust due to high-tech polyester mesh reinforcement
- Extremely abrasion resistant due to high surface hardness
- Extremely ergonomic with 5-finger tube protector –no kinking, easy handling

FLEXTREM Oilshield

- Extremely resistant to oil, petrol, diesel and grease
- Extremely flexible at temperatures from -30 °C up to +85 °C
- Extremely durable with ozone-resistant rubber compound for protection against extreme weather conditions
- Extremely robust due to high-tech polyester mesh reinforcement
- Extremely abrasion resistant due to high surface hardness
- Extremely ergonomic with 5-finger tube protector –no kinking, easy handling



E40440



E40444



E40470



E40474



Inner-Ø (DN) × Wall thickness (mm)	Thread (female thread)	Length (m)	Order No.
Full roll			
6 × 3	–	50	E40440
9.5 × 3	–	50	E40441
13 × 3.5	–	50	E40442
19 × 5	–	50	E40452
25 × 5.5	–	50	E40453
Pre-assembled with brass thread			
6 × 3	G ¼	5	E40443
6 × 3	G ¼	10	E40444
6 × 3	G ¼	20	E40445
9.5 × 3	G ⅜	5	E40446
9.5 × 3	G ⅜	10	E40447
9.5 × 3	G ⅜	20	E40448
13 × 3.5	G ½	5	E40449
13 × 3.5	G ½	10	E40450
13 × 3.5	G ½	20	E40451



Inner-Ø (DN) × Wall thickness (mm)	Thread (female thread)	Length (m)	Order No.
Full roll			
6 × 3	–	50	E40470
9.5 × 3	–	50	E40471
13 × 3.5	–	50	E40472
Pre-assembled with brass thread			
6 × 3	G ¼	5	E40473
6 × 3	G ¼	10	E40474
6 × 3	G ¼	20	E40475
9.5 × 3	G ⅜	5	E40476
9.5 × 3	G ⅜	10	E40477
9.5 × 3	G ⅜	20	E40478
13 × 3.5	G ½	5	E40479
13 × 3.5	G ½	10	E40480
13 × 3.5	G ½	20	E40481

Technical data

Model	BluBird	Oilshield
Temperature range	-50 °C up to +90 °C	-30 °C up to +85 °C
Max. operating pressure	20 bar/290 psi –independent of hose width	20 bar/290 psi –independent of hose width
Burst pressure	≥80 bar / ≥1160 psi	≥80 bar / ≥1160 psi
Material thread	brass C36000	brass C36000
Fire ignition delay	good	excellent
Ozone resistance	excellent	good
Abrasion resistance	excellent	excellent
Oil resistance	good	excellent

Notice

- !** All pre-assembled hoses are supplied as full rolls with internal threads so that any couplings and connections can be used.

Spiral hoses, polyamide

Hoses completely integrated with rotatable connection threads on both sides in zinc-plated brass as well as a version with coupling and plug (both steel). Resistant to cross-section constriction, kink-resistant due to kink protection spring. Extremely flexible and extremely elastic. Due to their long reach and simultaneous space saving, they are used as tool hoses especially in industry, trade and workshops for cleaning work surfaces and parts. They have an excellent run on smooth floors and are temperature and pressure resistant. They also have a long service life and good chemical resistance.

Spiral hose, polyamide 12

The maximum extension length (stretched length) is approx. 20% more than the working length.

Hose-Ø D × d (mm)	Working length (m)	Outer-Ø (mm)	Thread	Working pressure at 21 °C (bar)	Order No.
With connection thread (zinc-plated brass)					
6 × 4	2.5	75	G ¼	33.6	E40940
8 × 6	2.5	75	G ¼	23.2	E40941
8 × 6	5	75	G ¼	23.2	E40942
8 × 6	7.5	75	G ¼	23.2	E40943
8 × 6	10	75	G ¼	23.2	E40944
10 × 8	2.5	115	G ¼	18.4	E40945
10 × 8	5	115	G ¼	18.4	E40946
10 × 8	7.5	115	G ¼	18.4	E40947
10 × 8	10	115	G ¼	18.4	E40948
12 × 10	5	140	G ¾	16.8	E40949
12 × 10	7.5	140	G ¾	16.8	E40950
12 × 10	10	140	G ¾	16.8	E40951
Completely assembled with DN 7.2 coupling and plug (steel)					
6 × 4	2.5	75	–	33.6	E40970
8 × 6	2.5	75	–	23.2	E40971
8 × 6	5	75	–	23.2	E40972
8 × 6	7.5	75	–	23.2	E40973
8 × 6	10	75	–	23.2	E40974
10 × 8	2.5	115	–	18.4	E40975
10 × 8	5	115	–	18.4	E40976
10 × 8	7.5	115	–	18.4	E40977
10 × 8	10	115	–	18.4	E40978
12 × 10	5	140	–	16.8	E40979
12 × 10	7.5	140	–	16.8	E40980
12 × 10	10	140	–	16.8	E40981



E40941



E40972

Technical data

Hose-Ø D × d (mm)	Outer-Ø (mm)	Burst pressure		Working pressure (p ₂)	
		at 21 °C	at 50/60 °C	at 21 °C	at 50/60 °C
6 × 4	75	≥84	≥48	33.6	19.2
8 × 6	75	≥58	≥35	23.2	14
10 × 8	115	≥46	≥26	18.4	10.4
12 × 10	140	≥42	≥24	16.8	9.6

* Operating temperature: -40 °C up to +100 °C

Anti-kink spring

For spiral hoses. Material: zinc-plated spring steel.

Hose-Ø D × d (mm)	Thread	SW (AF)	Order No.
6 × 4	M10 × 1	12	474-10
8 × 6	M12 × 1	14	474-30

GEV 401.XXX see page 128 (pay attention of Hose-Ø)



401.XXX

474-10

Spiral hoses, polyurethane

Hoses completely integrated with rotatable connection threads on both sides (zinc-plated brass) as well as with coupling and plug in two versions (both steel). Connections with sealing ring. Resistant cross-section constrictions. With axial connections. Kink resistant due to kink protection. Extremely flexible and extremely elastic. Due to their long reach and simultaneous space saving, they are used as tool hoses especially in industry, trade and workshops for cleaning work surfaces and parts. The risk of scratching sensitive surfaces is very low due to the soft surface and the resulting low abrasion. They have an excellent run on smooth floors and are low-noise. Their long service life and good chemical resistance as well as cut resistance to chips are convincing advantages.

Spiral hose, polyurethane

The maximum extension length (stretched length) is approx. 20 % more than the working length.



E40804



E40824



E40924

Hose-Ø D × d (mm)	Working length (m)	Outer-Ø (mm)	Thread	Working pressure at 21 °C (bar)	Order No.
With connection thread (zinc-plated brass)					
8 × 5	3	40	G ¼	18	E40801
8 × 5	6	40	G ¼	18	E40802
8 × 5	7.5	40	G ¼	18	E40803
10 × 6.5	3.5	60	G ¼	16.8	E40804
10 × 6.5	6	60	G ¼	16.8	E40805
10 × 6.5	7.5	60	G ¼	16.8	E40806
10 × 6.5	10	60	G ¼	16.8	E40807
12 × 8	3	80	G ¾	16	E40808
12 × 8	6	80	G ¾	16	E40809
12 × 8	7.5	80	G ¾	16	E40810
12 × 8	10	80	G ¾	16	E40811

Completely assembled with DN 7.2 coupling and plug (steel)					
8 × 5	3	40	–	18	E40821
8 × 5	6	40	–	18	E40822
8 × 5	7.5	40	–	18	E40823
10 × 6.5	3.5	60	–	16.8	E40824
10 × 6.5	6	60	–	16.8	E40825
10 × 6.5	7.5	60	–	16.8	E40826
10 × 6.5	10	60	–	16.8	E40827
12 × 8	3	80	–	16	E40828
12 × 8	6	80	–	16	E40829
12 × 8	7.5	80	–	16	E40830
12 × 8	10	80	–	16	E40831

Completely assembled with DN 7.4 pushbutton safety coupling and plug (steel)					
8 × 5	3	40	–	18	E40921
8 × 5	6	40	–	18	E40922
8 × 5	7.5	40	–	18	E40923
10 × 6.5	3.5	60	–	16.8	E40924
10 × 6.5	6	60	–	16.8	E40925
10 × 6.5	7.5	60	–	16.8	E40926
10 × 6.5	10	60	–	16.8	E40927
12 × 8	3	80	–	16	E40928
12 × 8	6	80	–	16	E40929
12 × 8	7.5	80	–	16	E40930
12 × 8	10	80	–	16	E40931

Technical data

Hose-Ø D × d (mm)	Outer-Ø (mm)	Burst pressure		Working pressure (p ₂)	
		at 21 °C	at 50/60 °C	at 21 °C	at 50/60 °C
8 × 5	40	≥45	≥20	18	8
10 × 6.5	60	≥42	≥19	16.8	7.6
12 × 8	80	≥40	≥18	16	7.2

Operating temperature: -40 °C up to +85 °C

PVC fabric hose

PVC fabric hose with fabric insert, crystal clear, conditionally oil, petrol and alkali resistant. Standard hose for a wide range of applications in industry, mechanical and plant engineering, trade and laboratories. PVC hoses are resistant to pressure, UV radiation, ageing and have unlimited shelf life.

Inner-Ø (DN) × Wall thickness (mm)	Pressure at 20 °C air (bar)	Length (m)	Order No.
Full roll 50 m, without connections			
6 × 3	15	50	E40013
8 × 3	15	50	E40021
9 × 3	15	50	E40014
10 × 3	15	50	E40027
13 × 3.5	15	50	E40015
19 × 4	15	50	E40019
25 × 4.5	12	25	E40020
Completely assembled with DN 7.2 coupling and plug (brass)			
6 × 3	15	5	E40200
6 × 3	15	10	E40201
6 × 3	15	15	E40202
6 × 3	15	20	E40203
6 × 3	15	25	E40204
6 × 3	15	30	E40205
6 × 3	15	35	E40206
6 × 3	15	40	E40207
6 × 3	15	45	E40208
6 × 3	15	50	E40209
9 × 3	15	5	E40210
9 × 3	15	10	E40211
9 × 3	15	15	E40212
9 × 3	15	20	E40213
9 × 3	15	25	E40214
9 × 3	15	30	E40215
9 × 3	15	35	E40216
9 × 3	15	40	E40217
9 × 3	15	45	E40218
9 × 3	15	50	E40219
13 × 3.5	15	5	E40250
13 × 3.5	15	10	E40251
13 × 3.5	15	15	E40252
13 × 3.5	15	20	E40253
13 × 3.5	15	25	E40254
13 × 3.5	15	30	E40255
13 × 3.5	15	35	E40256
13 × 3.5	15	40	E40257
13 × 3.5	15	45	E40258
13 × 3.5	15	50	E40259



E40014



E40210

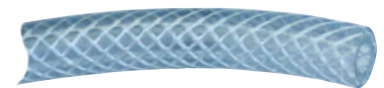

Technical data

Temperature range	-15 °C up to +60 °C
Burst pressure	approx. ≥60 bar / 870 psi (≥48 bar / 696 psi at DN 25)
Inner tube	PVC plain
Pressure carrier (tissue inlay)	polyester threads
Cover	PVC, cadmium and silicone free

Notice



When the hose is used with flowing oils, the plasticiser will be removed from the PVC. As a result, the hose loses its UV resistance and becomes brittle. Suitable for foodstuffs.



E40412



E40710



E40741



E40702



E40039

PVC compressed air hose SOFT

TÜV-tested according to TÜV PS PPP 53103 09.96. A three-layer, dimensionally stable PVC hose with a cross fabric insert made of high-quality polyester yarns in soft technology. Suitable for gaseous media up to 15 bar/217 psi and for liquid media up to 20 bar/290 psi. The compressed air hose has a very high flexibility, even at low temperatures, low weight and high compressive strength. For applications with particularly high requirements, UV-resistant, long-lasting and oil and petrol repellent. Colour light blue. Areas of application: compressed air industry, plant construction, workshops, industry and everywhere, where pneumatic tools are used.

Inner-Ø (DN) × Wall thickness (mm)	Minimum bend radius (mm)	Length (m)	Order No.
Full roll 50 m, without connections			
6.3 × 2.35	23	50	E40410
8 × 2.5	28	50	E40411
9 × 2.75	32	50	E40412
10 × 2.75	35	50	E40413
12.7 × 3.15	45	50	E40414
Completely assembled with DN 7.2 coupling and plug (steel)			
9 × 2.75	32	5	E40710
9 × 2.75	32	10	E40711
9 × 2.75	32	15	E40712
9 × 2.75	32	20	E40713
Completely assembled with DN 7.4 pushbutton safety coupling and plug (steel)			
9 × 2.75	32	5	E40740
9 × 2.75	32	10	E40741
9 × 2.75	32	15	E40742
9 × 2.75	32	20	E40743

Technical data

Temperature range	-20 °C up to +60 °C
Max. operating pressure (p ₁) [compressed air/water]	15/20 bar / 217/290 psi
Burst pressure	≥60 bar / 870 psi
Inner tube	PVC, extra soft, black
Pressure carrier (tissue inlay)	polyester
Cover	PVC, extra soft, cadmium- and silicone-free
Pressure support	high-strength synthetic yarn

Hose buffer

For direct connection to **percussive pneumatic tools**. Prevents premature wear of couplings and plugs. Hose: PVC compressed air hose SOFT DN 9, flexible, oil and petrol repellent and UV resistant. Length approx. 20 cm.

Thread inlet	Thread outlet	Max. pressure (bar/psi)	Order No.
Coupling plug DN 7.2 (steel)	Threaded hose connection G ¼ male (brass)	15/217	E40702

Special compressed air hose

With high flexibility, low weight and high compressive strength. Resistant to the effects of various oils, greases, diluted acids and alkalis. Silicone- and LABS-free as well as antistatic. Areas of application: as cooling line for welding machines, as pneumatic and hydraulic line in hose packages and for pneumatic devices.

Inner-Ø (DN) × Wall thickness (mm)	Operating pressure (air) at 20 °C (bar)	Minimum bend radius (mm)	Length (m)	Order No.
Full roll 50 m				
6 × 1.1	38	60	50	E40039
9 × 1.3	30	70	50	E40040
13 × 2.3	18	100	50	E40041

Technical data

Temperature range	-20 °C up to +60 °C
Cold rupture temperature (according to DIN 53372)	< -20 °C
Burst pressure	operating pressure × 3.5
Inner tube	soft PVC
Pressure carrier (tissue inlay)	high-strength polyester fibre
Cover	PVC

Paint and compressed air hose

This hose is designed for extreme conditions and consists of three-layer, silicone-free thermoplastic. It is reinforced with a polyester fabric insert. The hose cover protects against oil, grease, paint and hydrocarbons. It can also dissipate electrostatic voltages. **Typical applications:** repair workshops, paint shops, automotive industry, plastics processing, assembly companies and carpentry shops.

Inner-Ø (DN) x Wall thickness (mm)	Pressure at 20 °C (bar)	Length (m)	Order No.
Full roll 40 m, without connections			
9 x 3.5	16	40	E40502
Completely assembled with DN 7.2 coupling and plug (brass)			
9 x 3.5	16	8	E40500
9 x 3.5	16	10	E40510
9 x 3.5	16	15	E40515
Completely assembled with DN 7.4 pushbutton safety coupling and plug (steel)			
9 x 3.5	16	10	E40520

Technical data

Temperature range	-20 °C up to +90 °C
Burst pressure	≥64 bar/928 psi
Inner tube	antistatic soft PVC, soft PVC layer
Pressure support	polyester fabric reinforcement
Cover	PVC

PVC compressed air hose

Compressed air hose in extruded version with insert. Suitable for rough application conditions (DIN 20018). Resistant to compressed air containing water and mineral oil. Flexible, kink-resistant, abrasion-resistant, weather-resistant.

Inner-Ø (DN) x Wall thickness (mm)	Pressure at 20 °C (bar)	Length (m)	Order No.
Full roll 50 m, without connections			
5 x 4.5	25	50	E40460
6 x 3	15	50	E40461
9 x 3	12	50	E40462

Technical data

Temperature range (compressed air/water)	-20 °C up to +70 °C/up to +90 °C
Burst pressure	≥40 bar/580 psi
Inner tube/Pressure support	PVC, black, plain/spiralized synthetic textile yarns
Cover	PVC, black, plain, abrasion-resistant, weather-resistant

PU Compressed air hose

This hose has high flexibility even at low temperatures. It is made of silicone-free polyurethane with a particularly smooth surface that does not interfere with the paintwork. Reinforced by its polyester fibre fabric insert, it can also be used under high pressure conditions. This gives it an extremely long service life. Also suitable as a replacement hose for hose reels E48320/E48340.

Inner-Ø (DN) x Wall thickness (mm)	Pressure at 23 °C (bar)	Length (m)	Order No.
Full roll 50 m, without connections			
8 x 2	13.7	50	E48330
9.5 x 2	13.7	50	E48350

Technical data

Temperature range (compressed air)	-20 °C up to +60 °C
Max. operating pressure (p ₁)	14 bar/203 psi
Burst pressure	≥56 bar/812 psi
Materials	PU with PE fabric



E40502



E40500



E40520



E40460



E48350

Pneumatic hose, polyethylene / polyamide

Flexible hose, without reinforcement. Available in transparent polyethylene (PE) or natural coloured polyamide (PA). Full roll (50 m) without connections.



E40350, E40353, E40352

Inner-Ø (DN) × Wall thickness (mm)	Operating pressure (bar)			Order No.
	20 °C	40 °C	60 °C	
Polyethylene, transparent, flexibel				
4 × 1	10	5	–	E40350
6 × 1	8	4	–	E40351
8 × 1	6	3	–	E40353
9 × 1.5	8	4	–	E40352
Polyamide, natural coloured				
4 × 1	27	18	15	E40362
6 × 1	19	13	11	E40361
8 × 1	12.5	9	7	E40363
9 × 1.5	16	11	9	E40360

Technical data

Max. operating pressure (p ₁)	see table at: 20 °C, 40 °C, 60 °C
Temperature range	0 °C up to +80 °C (PE)/0 °C up to +100 °C (PA 11)
Material (without reinforcement)	polyethylene/polyamide
Roll length	50 m

Hose clamps



E41008



E41021



E41025



E41030



E41055

Version	Bandwidth (mm)	Clamping range (mm)	Order No.	
With spiral thread. Band and housing made of stainless steel (1.4016). Zinc-plated screw	9	8–12	E41008	
	9	10–16	E41042	
	9	12–20	E41009	
	9	16–27	E41010	
	9	20–32	E41011	
	9	25–40	E41012	
	9	32–50	E41013	
	9	40–60	E41014	
	9	50–70	E41015	
	9	60–80	E41016	
	9	70–90	E41017	
	9	80–100	E41018	
	9	90–110	E41019	
	1-ear hose clamps. Material: stainless steel (1.4016)	6	7.5–9	E41021
		6	8.5–10	E41022
		6	10.3–12.3	E41023
		6	12.3–14.3	E41024
	1-ear hose clamps with inner ring. Material outer and inner ring: stainless steel (1.4016)	6.4	6.3–7.5	E41025
		7.4	7.5–9	E41026
7.4		8.8–10.5	E41027	
7.4		10.3–12.3	E41028	
8.2		12.3–14.3	E41029	
2-ear hose clamps. Material: zinc-plated, bright steel	5	3.4–5	E41041	
	6	5–7	E41040	
	7	7–9	E41030	
	7	8.8–11	E41031	
	7	10.8–13	E41032	
	7.5	12.5–15	E41033	
	8	15–18	E41034	
	8.5	16.2–20	E41035	
	10	21–25	E41036	
	Infinitely variable ear clamps stainless steel (1.4016)	7	10.8–13.3	E41055
7		13.5–15.7	E41056	
7		15–17.5	E41057	

Strainers

For liquids, gases, vapours, water, mineral, heating and hydraulic oils, fuels and other non-aggressive media in liquid and gaseous form. With double sieve insert made of stainless steel for fine filtration. Material: brass.

Thread	DN	C	L	SW1 (AF1)	SW2 (AF2)	Order No.
G ¼	8	35	43	18	13	397.022
G ⅜	10	39	49	22	14	397.023
G ½	15	46	55.5	25.5	21	397.024
G ¾	20	57	70	32.5	24	397.025
G 1	25	62	82	38.5	32	397.026
G 1¼	32	73	90	48.5	35	397.027
G 1½	40	87	101	55	39	397.028
G 2	50	102	123.5	66	45	397.029

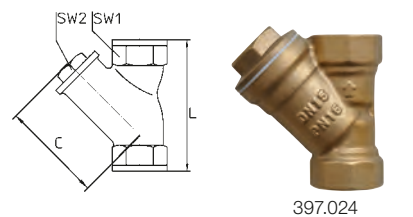

397.024

Technical data

Max. operating pressure (p ₁)	10 bar / 145 psi
Max. operating temperature	110 °C
Mesh width sieve insert	0.2 mm
Material housing/headpiece	brass
Material double sieve insert	stainless steel

Hose break protection – Hose Guard

Effective hose and pipe burst protection for compressed air systems. Designed for the required amount of air to operate pneumatic tools. In case of a burst hose or pipe, Flow Stop immediately restricts the flow rate except of a marginal residual flow. The affected segment or the hose can be safely replaced, while the undamaged parts of the compressed air network remain under full pressure. The residual flow slowly refills the segment after the repair. As soon as the working pressure level is reached, Hose Guard opens the line again for normal operation.

- Protects personnel and working environment from damage that can occur when a compressed air system or hose bursts.
- Complies with EU standard EN 983 - § 5.3.4.3.2
- Operation and adjustment secured
- Can be installed in any compressed air system

Also available with NPT thread on request.

Thread	Length (mm)	SW (AF)	Pre-pressure (bar)	Max. flow rate* (l/min)	Order No.
Inlet: male thread, outlet: female thread					
G ¼	57	22	max. 18	760	396.032
G ⅜	76	27	max. 18	1,080	396.033
G ½	80	30	max. 18	3,200	396.034
Inlet: female thread, outlet: female thread					
G ¼	48	22	max. 18	760	396.022
G ⅜	59	27	max. 18	1,020	396.023
G ½	65	30	max. 18	3,200	396.024
G ¾	76	33/36	max. 18	4,070	396.025
G 1	100	41/50	max. 35	5,220	396.026
G 2	130	70/80	max. 35	12,920	396.029

* at 8 bar



396.033



396.023

Technical data

Operating temperature G ¼ – G ⅜	-20 °C up to +80 °C
Operating temperature G 1 – G 2	-20 °C up to +120 °C
Mounting position	in front of a clutch, after a maintenance unit
Material piston	G ¼ – G ½ POM / G ¾ – G 2 aluminium
Material housing / O-ring (seal) / spring	aluminium / NBR / stainless steel

Compressed air hose reel

Compressed air hose reel with ergonomic handle and rotation stop switch. Very stable due to low focal point. The hose reel is supplied either with DN 7.2 brass coupling and plug (PVC hose) or with DN 7.2 steel coupling and plug (compressed air hose SOFT). Hose size (inner-Ø) DN 9.

Hose length 20 m.

Hose type	Coupling/Plug	Order No.
PVC fabric hose	DN 7.2 brass	E48035
Compressed air hose SOFT	DN 7.2 steel	E48045

Technical data

Temperature range (compressed air)	-15 °C up to +60 °C
Max. operating pressure (p _i)	15 bar / 217 psi
Dimensions W x H x D x Ø	258 x 358 x 240 x 255 (mm)
Weight	approx. 4 kg
Material reel	plastic, blue
Material stand	steel



E48035

Suspended power distributor for electricity/compressed air

For the supply of electricity and compressed air directly above the workplace, no disturbing cables or hoses on the floor. Despite its compact dimensions, the innovative design offers a wide range of connection options for electricity and compressed air. The green or red light of the temperature control system (DiagS) signals the functionality of the connected device(s) and switches off automatically in the event of overheating. Protection class IP44 (splash-proof). Ideally suited for use in industry and workshops.

- Six safety sockets (earthed sockets) with 250 V outlet
- Two compressed air connections (up to 12 bar) each with a DN 7.4 safety coupling with push button
- Compressed air hose SOFT (9 x 2.75 mm), length 2 m, up to 15 bar / 217 psi (mounted)
- Suspension by zinc-plated knotted chain with snap hook, length 2 m
- Dimensions W x H x D: 227 x 305 x 212 mm

Artikel	Order No.
Suspended power distributor standard	E48200
Suspended power distributor standard + 1 Three-phase AC current socket 5-pin (3 L + N + PE), 16 A / 400 V	E48210



E48210

Wall-mounted hose holder

Material: light alloy cast (cast in one piece). Extremely stable, solid construction and processing. Available in three sizes.

Size	Dimensions (mm)						Order No.
	A	B	C	D	EØ	F	
I	188	147	70	150	6	78	E42070
II	266	201	108	225	6	107	E42071
III	348	257	144	170	8	136	E42072



E42070

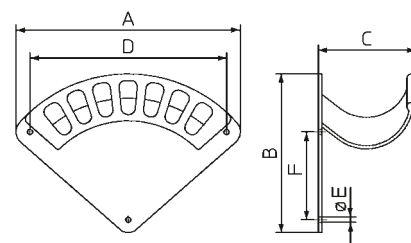

Mini ball valves

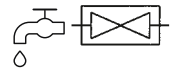

640.41

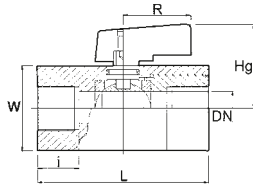

640.45

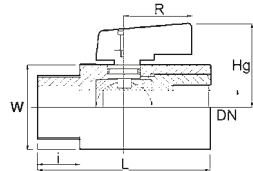

640.62

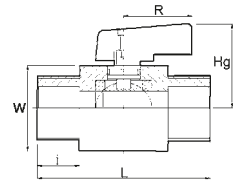

Mini ball valve with plastic lever

With full flow. Material: brass chromated.

Thread W	DN	Dimensions (mm)				Order No.
		L	Hg	R	i	
Female thread						
G 1/4	8	41.3	29	24.3	10	640.41
G 3/8	8	41.3	29	24.3	10	640.42
G 1/2	10	45	30.3	24.3	10	640.43
Female/male thread						
G 1/4	8	43.3	29	24.3	9	640.45
G 3/8	8	43.3	29	24.3	9	640.46
G 1/2	10	47	30.3	24.3	10	640.47
Male thread						
G 1/4	8	40.5	27	22	9	640.60
G 3/8	8	42.5	27	22	10	640.61
G 1/2	10	50	28.5	22	11	640.62

Technical data

Max. operating pressure (p ₁)	20 bar at 90 °C
Operating temperature	-10 °C up to +90 °C
Permissible media	non-flammable and non-toxic gases and liquids
Mounting position/flow direction	any/any
Material body, sleeve, shank	brass chromated
Material ball	chrome-plated brass
Material seal	PFTE
Material O-ring (seal)	NBR
Material lever	nylon 66
Material screw	zinc-plated steel

Mini ball valve with metal toggle

With full flow. Material: nickel-plated brass.



640.90

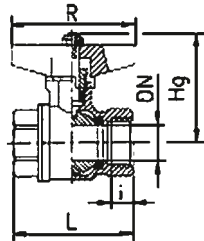

640.08

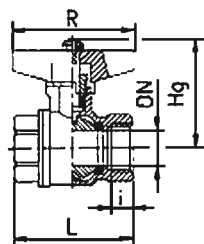

641.01

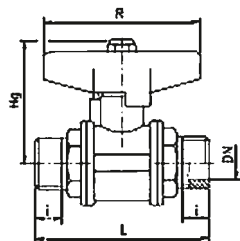

Thread	DN	Dimensions (mm)				Order No.
		L	Hg	R	i	
Female thread						
G 1/4	8	42	46	50	10	640.90
G 3/8	10	47	46	50	12	640.91
G 1/2	15	53	51.5	50	13.5	640.92
G 3/4	20	60.5	54.5	50	14.5	640.93
G 1	25	65	61.5	50	14	640.94
Female/male thread						
G 1/4	10	43	46	50	10	640.08
G 3/8	10	48	46	50	12	640.09
G 1/2	15	56.5	51.5	50	13.5	640.10
G 3/4	20	64	54.5	50	14.5	640.11
G 1	25	70	61.5	65	14	640.12
Male thread						
G 3/8	10	56	46	50	11.5	641.01
G 1/2	15	63.5	51.5	50	10	641.02
G 3/4	20	55	54.5	50	12	641.03
G 1	25	69	61.5	65	13	641.04

Technical data

Max. operating pressure (p ₁)	30 bar (PN 30) (at medium temperature approx. room temperature)
Operating temperature	-20 °C up to +130 °C
Permissible media	non-flammable and non-toxic gases and liquids
Mounting position/flow direction	any/any

Ball valves

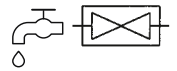

Ball valve with metal lever

With **full flow**. Material: nickel-plated brass.

Thread	DN	Dimensions (mm)					SW(AF)	Order No.
		L	Hg	R	i1/i2			
Female thread								
G ¼	10	42	46	85	10	23	640.13	
G ⅜	10	57	46	85	12	23	640.14	
G ½	15	57	52	85	13	30	640.15	
G ¾	20	64	55	85	14	37	640.16	
G 1	25	64	62	85	14	45	640.17	
G 1¼	32	70	73	100	15	55	640.18	
G 1½	40	89	79	140	16	68	640.19	
G 2	50	103	92	140	17	84	640.20	
Female/male thread								
G ¼	8	43	46	85	10/11	23	640.70	
G ⅜	10	48	46	85	12/11	23	640.71	
G ½	15	53	52	85	13/10	30	640.72	
G ¾	20	57	55	85	14/12	37	640.73	
G 1	25	64	62	140	14/13	45	640.74	
G 1¼	32	86	73	140	15/14	55	640.75	
G 1½	40	97	79	140	16/15	68	640.76	
G 2	50	114	92	140	17/17	84	640.77	
Male thread								
G ⅜	10	56	46	85	11	23	640.81	
G ½	15	63.5	52	85	10	30	640.82	
G ¾	20	60	55	85	12	37	640.83	
G 1	25	69	62	113	13	45	640.84	
G 1¼	32	84	73	141	14	55	640.85	
G 1½	40	97	79	141	15	68	640.86	
G 2	50	114	92	141	17	84	640.87	

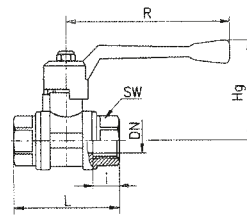

640.14

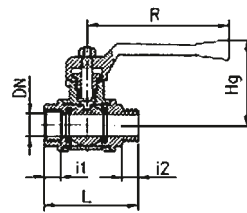

640.71

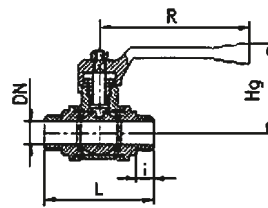

640.84

Technical data

Max. operating pressure (p ₁)	30 bar (PN 30) (at medium temperature approx. room temperature)
Operating temperature	-20 °C up to +120 °C
Permissible media	non-flammable and non-toxic gases and liquids
Mounting position/flow direction	any/any

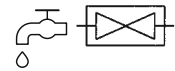

Compact ball valves

Compact ball valve with metal lever

With metal lever (steel). The passage corresponds to the nominal diameter of the connecting threads. Material: nickel-plated brass with chrome-plated ball. Seals of teflon.

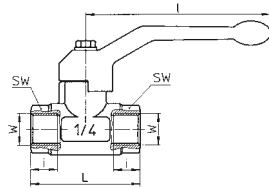

569.206



569.506

Thread W	DN	Dimensions (mm)				Order No.
		L	i	SW(AF)	I	
Female thread						
G ¼	8	44.4	10	25	80	569.202
G ⅜	10	44.4	10	25	80	569.204
G ½	15	50.5	12.5	31	80	569.206
G ¾	20	57.5	13.5	37	113	569.208
G 1	25	70	15	38	113	569.209
G 1¼	32	80.5	16.5	47	138	569.210
G 1½	40	94.5	17.5	54	138	569.211
G 2	50	112.5	20.5	66	158	569.212
Female/male thread						
G ¼	8	54	10.5	25	80	569.502
G ⅜	10	54	10.5	25	80	569.504
G ½	15	58.5	11.5	31	80	569.506
G ¾	20	66.5	13.5	37	113	569.508
G 1	25	78.5	14.5	38	113	569.509
G 1¼	32	91.5	17	47	138	569.510
G 1½	40	105.5	19	54	138	569.511
G 2	50	122	21	66	158	569.512

Technical data

MOP (p ₁) * G ¼ – G ½	50 bar
MOP (p ₁) * G ¾ – G 1	40 bar
MOP (p ₁) * G 1¼ – G 1½	30 bar
MOP (p ₁) * G 2	25 bar
Operating temperature	-40 °C up to +200 °C (seal PTFE)
Permissible media	non-flammable and non-toxic gases and liquids
Mounting position / flow direction	any / any
Material ball seal	PTFE (Teflon)
Material spindle seal	FKM
Marked with identification	embossed according to AD info-sheet A4

*max. operating pressure at medium temperature approx. room temperature

Compact ball valve with DVGW approval according to EN 331

With metal lever (steel). The passage corresponds to the nominal diameter of the connecting threads. Material: nickel-plated brass with chrome-plated ball. Seals of Teflon.

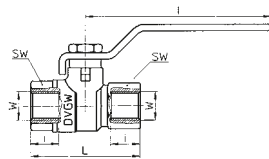

574.209



574.502

Thread W	DN	Dimensions (mm)				Order No.
		L	i	SW(AF)	I	
Female thread						
G ¼	8	49	13	18	80	574.202
G ⅜	10	52	13	21	80	574.204
G ½	15	61	16	25	89	574.206
G ¾	20	68	17	31	113	574.208
G 1	25	85	20	38	113	574.209
G 1¼	32	99	20	47	138	574.210
G 1½	40	109	22	54	160	574.211
G 2	50	130	24	66	160	574.212
Female/male thread						
G ¼	8	57	13	18	80	574.502
G ⅜	10	59	13	21	80	574.504
G ½	15	68	15	25	88	574.506
G ¾	20	75	17	31	113	574.508
G 1	25	90	18	38	113	574.509
G 1¼	32	105	20	47	137	574.510
G 1½	40	115	25	54	157	574.511
G 2	50	135	25	66	157	574.512

Technical data

Max. operating pressure (p ₁)	5 bar (MOP5, PN 16 with compressed air)
Operating temperature	-10 °C up to +80 °C (seal PTFE)
Permissible media	flammable gases except acetylene and hydrogen
Mounting position / flow direction	any / any
Material ball seal	PTFE (teflon)
Material spindle seal	FKM
Marked with identification	embossed according to DVGW

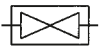

Shut-off and regulating valves

Shut-off valve

Two-way valves with manual operation. The sealing is metallic by a stainless steel ball. The stem is sealed by a NBR O-ring.

Thread W	DN	Dimensions (mm)				Order No.
		L	i	H	d	
Straight through form, male thread						
G 1/8	3.5	35	7	30	22	296.01
G 1/4	3.5	34	8	30	22	296.11
G 1/4	6	43	10	50	48	556.12
G 3/8	10	52	12	50	48	556.14
G 1/2	10	64	14	54	48	556.16
Straight through form, female thread						
G 1/4	6	43	11	50	48	556.22
G 3/8	9	52	12	50	48	556.24
G 1/2	11	63	15	57	48	556.26
Elbow form, male thread						
G 1/8	3.5	34	7	26	22	295.01
G 1/4	3.5	34	8	26	22	295.11

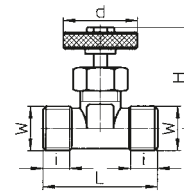

296.11

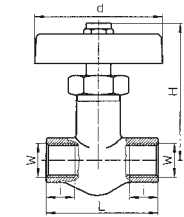

556.22

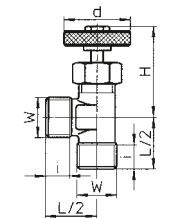

295.11

Needle regulating valve

Needle regulating valves are sealed by a brass-cone and thus allow a constant flow control.

Thread W	DN	Dimensions (mm)				Order No.
		L	i	H	d	
Straight through form, male thread						
G 1/4	4	42	11	52	50	558.12
G 3/8	4	42	11	52	50	558.14
G 1/2	11	65	15	60	50	558.16
Straight through form, female thread						
G 1/4	4	42	12	50	50	558.22
G 3/8	4	51	13	50	50	558.24
G 1/2	11	64	15	50	50	558.26

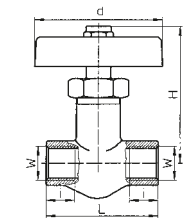

558.12

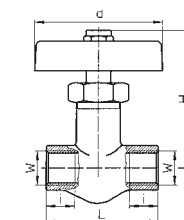

558.22

Technical data

Max. operating pressure (p ₁)	25 bar (PN 25) for DN 3.5/ 40 bar (PN 40) from DN 4 up
Operating temperature	-10 °C up to +90 °C
Permissible media	non-flammable and non-toxic gases, preferably air
Mounting position/flow direction	any/in arrow direction
Material	brass
Material handwheel	plastic/brass

Drain valves, manual slide valves



Drain valves

Drain valves, straight or in elbow form, are used to drain condensate at the lowest point of a pressure bowl. Today they are generally used as venting valves. Valves are with rubber or metal sealing, with handwheel or toggle. Material: brass.



166.12

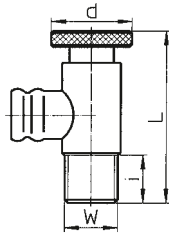

Thread W	DN	Dimensions (mm)				Order No.
		L	i	d	SW(AF)	
Elbow form, handwheel, rubber seal, brass						
G 1/8	5	43	9	20	-	166.02
G 1/4	5	43	12	20	-	166.12
Straight form, toggle, metal seal, nickel-plated						
G 1/8	5	35	7	40	12	212.01
G 1/4	5	35	10	42	14	168.11



168.11

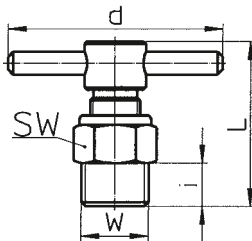

Technical data

Max. operating pressure (p ₁)	25 bar (PN 25)
Operating temperature	0 °C up to +90 °C
Mounting position	any



Manual slide valve (3/2-way valve)

Manual slide valves (3/2-way valves) are ideal fittings for devices which have to be vented when switching off, e.g. cement syringes, clamping cylinders, nailers, grinders, drills, screwdrivers. The shut-off separates the compressed air from the compressed air network. Simultaneous venting depressurises the units, preventing accidents or damage to tools caused by accidental actuation. To connect the manual slide valves to the compressed air network, hose couplings for plastic hoses, self-releasing couplings or quick-release couplings can be used. Three way and two switching positions by axial displacement of the sleeve. With clamping protection (extension on outlet side). Safe compressed air venting by axial discharge of the compressed air.



321.12

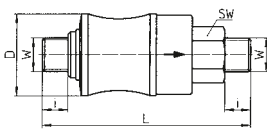

Thread W	D	Dimensions (mm)			Order No.
		L	i	SW (AF)	
G 1/8	26	72	8	14	321.11
G 1/4	32	81	10	19	321.12
G 3/8	37	85	10	22	321.14
G 1/2	44	98	12	27	321.16

Technical data

Max. operating pressure (p ₁)	12 bar
Min. operating pressure (p ₁)	1 bar
Operating temperature	0 °C up to +90 °C
Mounting position / flow direction	any/in arrow direction
Material housing	brass
Material sleeve	aluminium

Flow rates (Nominal flow rate in l/min)

Pre-pressure (bar)		2	4	6	8	10	12
321.11	G 1/8	489	815	1,090	1,850	2,120	2,465
321.12	G 1/4	1,090	1,810	2,175	3,620	4,350	5,080
321.14	G 3/8	1,810	2,900	4,530	5,620	6,885	8,880
321.16	G 1/2	2,720	4,170	5,980	7,610	9,060	10,870

Non-return valves



Non-return valves release the flow only in one direction and shut off in the opposite direction. They contain a soft seal (FKM) and are available in straight or T-form.

Thread W	DN	Dimensions (mm)					Order No.
		L	i	H	SW(AF)	k	
Straight through form, male thread							
M5	2	30	5	–	10	5	392.017
G ¼	8	49.5	6.5	–	22	9	392.012
G ⅜	8	53.5	11	–	22	11	392.013
G ½	12	70	13	–	27	13	392.014
G ¾	16	77	14	–	36	14	392.015
G 1	22	84	15	–	46	15	392.016
Straight through form, female thread							
M5	2	30	4.5	–	10	4.5	392.027
G ¼	8	45	9.5	–	22	11.5	392.022
G ⅜	8	47	10	–	22	11	392.023
G ½	12	57	11	–	27	13	392.024
G ¾	16	58	14	–	36	13	392.025
G 1	22	68	14	–	46	16	392.026
Straight through form, inlet: male thread – outlet: female thread							
G ¼	8	48.5	6.5	–	22	11.5	392.032
G ⅜	8	53.5	11	–	22	11	392.033
G ½	12	58	13	–	27	13	392.034
G ¾	16	63	14	–	36	11	392.035
G 1	22	81	15	–	46	16	392.036
Straight through form, inlet: female thread – outlet: male thread							
G ¼	8	48.5	6.5	–	22	9	392.042
G ⅜	8	53.5	10	–	22	11	392.043
G ½	12	58	11	–	27	13	392.044
G ¾	16	63	14	–	36	14	392.045
G 1	22	69	14	–	46	15	392.046
T-Form, female thread							
G ¼	6	42	11	30	17	–	566.22
G ⅜	7.5	48	12	30	22	–	566.24
G ½	10	64	15	36	27	–	566.26

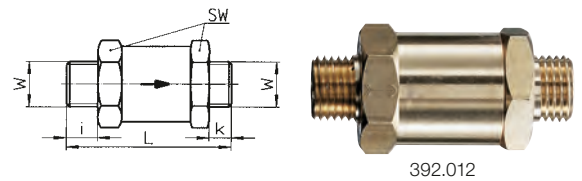

392.012

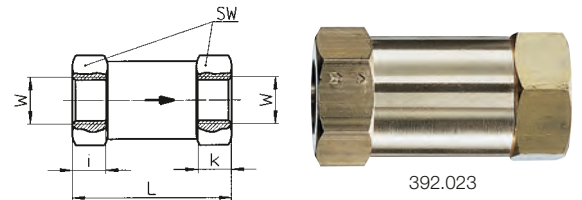

392.023

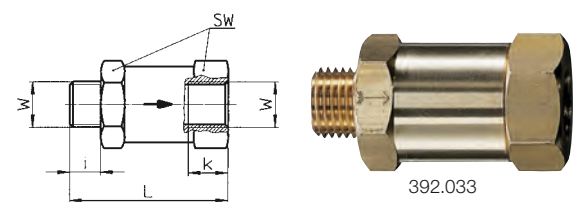

392.033

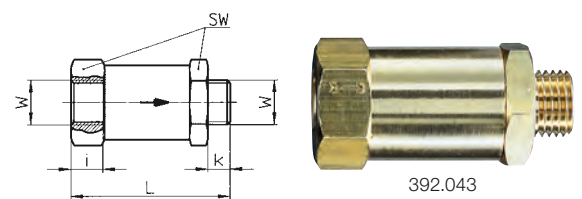

392.043

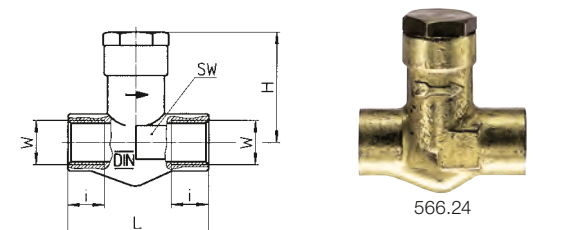

566.24

Technical data

Max. operating pressure (p ₁)	16 bar
Opening pressure straight form	~ 0.1 bar
Opening pressure T-form	0.5 up to 0.8 bar
Operating temperature	-10 °C up to +180 °C
Mounting position/flow direction	any/in arrow direction
Material housing	brass
Material seal	FKM
Material spring	spring steel

Flow rates of the passage forms

Thread	Nominal flow rate* (l/min)
M5	148
G ¼ and G ⅜	1,000
G ½	1,810
G ¾	3,440
G 1	6,160

*p₁ = 6 bar and Δp = 1 bar

Notice



The non-return valves in straight through form are not suitable as control valves for reciprocating compressors because of their low opening pressure.

Silencer from sintered bronze

Silencers are used to reduce exhaust air noise at compressed air consumers, cylinders, valves, etc. The solid design makes them suitable for high operating pressure and intermittent operation. Cleaning is possible with all conventional detergents.



573.3

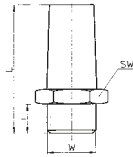

573.11

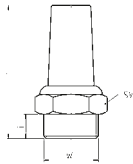

573.21

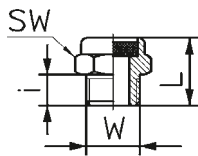

573.31

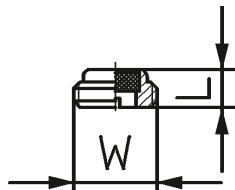

573.41

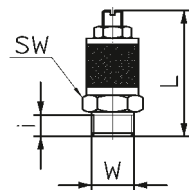

573.51

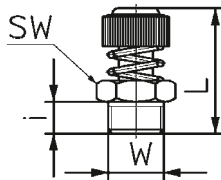

Silencers

Thread W	Dimensions (mm)			Filter porosity (µm)	Order No.
	L	i	SW(AF)		
Hexagon (fully sintered)					
G 1/8	28.5	6	13	40	573.1
G 1/4	33	8	17	40	573.2
G 3/8	36	10	22	40	573.3
G 1/2	44	12	27	40	573.6
G 3/4	54	14	32	40	573.8
G 1	66	16	41	40	573.9

Hexagon (brass)					
G 1/8	28	6	13	40	573.11
G 1/4	34.5	8	16	40	573.12
G 3/8	40.5	7.5	19	40	573.13
G 1/2	46	10	24	40	573.16
G 3/4	50	10	30	40	573.18
G 1	60.5	11.5	36	40	573.19

Hexagon, flat version					
G 1/8	13	6	13	100	573.21
G 1/4	16.5	8	16	100	573.22
G 3/8	16.5	7.5	19	100	573.23
G 1/2	19	10	24	100	573.26
G 3/4	19	10	30	100	573.28
G 1	22	12	36	100	573.29

Flat version with slot					
G 1/8	5	-	-	50	573.31
G 1/4	6	-	-	50	573.32
G 3/8	7	-	-	50	573.33
G 1/2	9	-	-	50	573.36
G 3/4	8	-	-	50	573.38
G 1	10	-	-	50	573.39

Throttle silencer, adjustable

The exhaust air volume can be adjusted via an adjusting screw.

Thread W	Dimensions (mm)			Filter porosity (µm)	Order No.
	L	i	SW(AF)		
Hexagon (brass), fixed with a counter nut					
G 1/8	44	8	16	50	573.41
G 1/4	45	8	16	50	573.42
G 3/8	50	10	22	50	573.43
G 1/2	50	10	22	50	573.46
G 3/4	78	13	30	50	573.48
G 1	82	13	36	50	573.49

Knurled screw, fixed by spring force					
G 1/8	30	6	13	100	573.51
G 1/4	34.5	8	15	100	573.52
G 3/8	40.5	7.5	19	100	573.53
G 1/2	46	10	24	100	573.56
G 3/4	47	10	30	100	573.58
G 1	46.5	11.5	36	100	573.59

Technical data

Max. back pressure 573.21-39/573.51-59	16 bar
Max. back pressure 573.1-9/573.11-19/ 573.41-49	12 bar
Operating temperature	-10 °C up to +180 °C
Mounting position	any

Silencers (plastic, steel)



Plastic silencer

For the reduction of exhaust air noise at compressed air consumers, cylinders, valves, etc.

Thread W	Dimensions (mm)			Order No.
	L	i	D	
G ¼	43	8	20	573.62
G ⅜	57	10	24	573.63
G ½	57	10	24	573.64



573.62

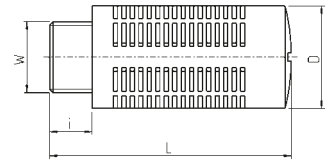

Technical data

Max. back pressure	6 bar
Operating temperature	-10 °C up to +90 °C
Mounting position	any
Material housing/damping	plastic/plastic balls

High-performance multi-chamber silencer

High-performance multi-chamber silencers are designed continuous volume flows. This silencer combines the three most important requirements for a silencer: high blow-off volume, short venting time and large silencing. The axial air outlet allows blowing out in a safe direction. Temperatures up to 90 °C in continuous operation. Oil and water resistant. Cleaning possible by blowing out with compressed air.

Thread W	Dimensions (mm)			Flow rate*		Noise level dB(A)**	Order No.
	L	i	D	(m³/h)	(l/min)		
G ½	103	14	80	800	13,350	88	391.106
G ¾	106	16	80	1,000	16,700	88	391.108
G 1	130	18	110	1,400	23,350	88	391.109
G 1¼	136	20	110	1,900	31,700	89	391.110
G 1½	168	24	150	3,200	53,400	91	391.111
G 2	168	24	150	3,400	56,700	92	391.112

* noise level at 6 bar back pressure

** at 1.5 m distance



391.106

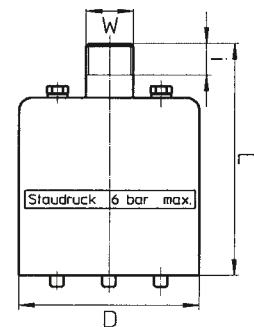

Technical data

Max. back pressure	6 bar
Operating temperature***	-10 °C up to +90 °C
Mounting position	any
Material housing, perforated plates, connection piece	zinc-plated steel
Material filter discs	polyester felt, resin bonded, non-aging
Material cover caps/spacers	PVC, black/Lupolen 6011L

*** pay attention to air condition below +2 °C. To ensure safe operation of the valve and silencer, the air must be dry enough to prevent ice from forming on the silencer.

Safety silencers

Silencers are used to reduce exhaust air noise at compressed air consumers, cylinders, valves, etc. These safety silencers are used for effective noise reduction in case of short-term flow peaks as they occur when relieving pressurized volumes. The deflector plates and filter discs are flexibly mounted. Features: short venting time and high blow-off rate. The axial air outlet allows blowing in a non-hazardous direction. Temperatures up to 60 °C in continuous operation. Oil and water resistant. Cleaning possible by blowing out with compressed air. Inlet damper is decoupled.

Thread A	Dimensions (mm)		Pressure reduction time (ms)****	Noise level dB(A)	Order No.
	B	C			
G 1	200	182	120	84	391.509
G 1½	200	196	93	87	391.511
G 2	200	196	77	86	391.212

**** V = 5l, p₁ = 6 bar



391.509

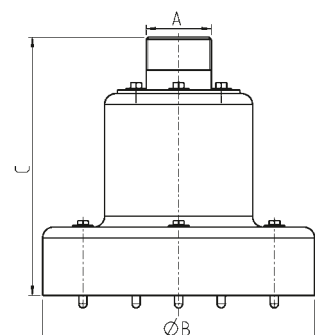

Technical data

Max. back pressure	6 bar
Operating temperature*****	-10 °C up to +60 °C
Mounting position	any, thread axial
Material housing, deflector plates, connection piece	zinc-plated steel
Material spring	spring steel
Material filter discs	polyester felt, resin bonded, non-aging
Material cover caps/spacers	PVC, black/Lupolen 6011L

***** pay attention to air condition below +2 °C. To ensure safe operation of the valve and silencer, the air must be dry enough to prevent ice from forming on the silencer.

Pressure gauges Ø 40 and Ø 50



Pressure gauge according to EN 837-1

Bourdon tube pressure gauge with horizontal (rear) or vertical (bottom) connections. Various indication ranges: the indication range should be used between 2/3 and 3/4, this means a pressure reducer with a control range of 0.5–10 bar should be equipped with a pressure gauge with an indicator range of 0–16 bar.



Pressure gauges Ø 40

Display in bar and psi. With brass thread. Plastic disc, housing ABS black. Tmax 60 °C.

Thread	Display range (bar)	Ground/Printing	Order No.
Horizontal connection, class 2.5			
G 1/8	0–2.5	black/white	640
G 1/8	0–4	black/white	650
G 1/8	0–6	black/white	660
G 1/8	0–10	black/white	670
G 1/8	0–16	black/white	680
G 1/8	0–25	black/white	690
G 1/4	0–2.5	black/white	708
G 1/4	0–4	black/white	709
G 1/4	0–6	black/white	714
G 1/4	0–10	black/white	723
G 1/4	0–16	black/white	734
G 1/4	0–25	black/white	745
M8 x 1	0–3	black/white	669
M8 x 1	0–6	black/white	673
M8 x 1	0–10	black/white	674
M8 x 1	0–16	black/white	675
Horizontal connection, version with additional colour code (red/green), class 2.5			
G 1/4	0–16	white/black/red-green	746
Horizontal connection, version with steel housing (black), class 1.6			
G 1/4	0–4	white/black	401
G 1/4	0–6	white/black	402
G 1/4	0–10	white/black	403

Pressure gauges Ø 50

Display in bar and psi. With brass thread. Plastic disc, housing ABS black. Tmax 60 °C.

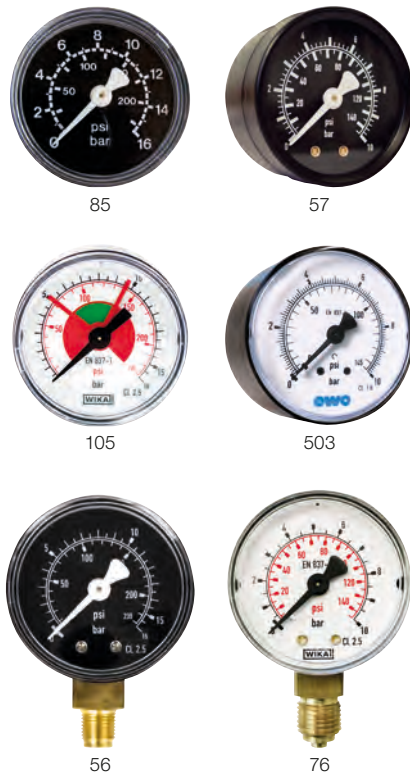

Thread	Display range (bar)	Ground/Printing	Order No.
Horizontal connection, class 2.5			
G 1/4	0–2.5	black/white	40
G 1/4	0–4	black/white	41
G 1/4	0–6	black/white	42
G 1/4	0–10	black/white	55
G 1/4	0–16	black/white	85
G 1/4	0–25	black/white	96
Horizontal connection, version with glass screen and steel housing (black), class 2.5			
G 1/4	0–6	black/white	44
G 1/4	0–10	black/white	57
G 1/4	0–16	black/white	89
Horizontal connection, version with color code (red/green) and steel housing, class 2.5			
G 1/4	0–16	white/black/red-green	105
Horizontal connection, version with steel housing (black), class 1.6			
G 1/4	0–4	white/black	501
G 1/4	0–6	white/black	502
G 1/4	0–10	white/black	503
Vertical connection, class 2.5			
G 1/8	0–16	black/white	56
G 1/4	0–16	black/white	70
G 1/4	0–2.5	white/black-red	73
G 1/4	0–4	white/black-red	74
G 1/4	0–6	white/black-red	75
G 1/4	0–10	white/black-red	76
G 1/4	0–16	white/black-red	77
G 1/4	0–25	white/black-red	78
G 1/4	0–40	white/black-red	79

Pressure gauges Ø63

Pressure gauge according to EN 837-1

Stainless steel pressure gauges Ø63

Display in bar. With brass thread. Plastic disc, stainless steel housing. Class 1.6. Tmax 60 °C.

Thread	Display range (bar)	Ground/Printing	Order No.
Horizontal connection			
G ¼	0-6	white/black-red	141
G ¼	0-16	white/black-red	143
G ¼	0-25	white/black-red	144



141

Pressure gauges Ø63

Display in bar and psi. With brass thread. Plastic disc, housing ABS black. Class 2.5. Tmax 60 °C.

Thread	Display range (bar)	Ground/Printing	Order No.
Horizontal connection			
G ¼	0-2.5	black/white	211
G ¼	0-4	black/white	212
G ¼	0-6	black/white	213
G ¼	0-10	black/white	214
G ¼	0-16	black/white	215
G ¼	0-25	black/white	216
G ¼	0-40	black/white	217
G ¼	0-60	black/white	218



215

Vertical connection

G ¼	0-2.5	white/black-red	173
G ¼	0-4	white/black-red	174
G ¼	0-6	white/black-red	175
G ¼	0-10	white/black-red	176
G ¼	0-16	white/black-red	177
G ¼	0-25	white/black-red	178
G ¼	0-40	white/black-red	179



175

Glycerine pressure gauges Ø63

For applications with high dynamic vibration or shock loads. Highly resistant due to glycerine filling. Display in bar and psi. With brass thread. Plastic disc, stainless steel housing. Class 1.6. Tmax 60 °C.

Thread	Display range (bar)	Ground/Printing	Order No.
Horizontal connection			
G ¼	0-2.5	white/black-red	183
G ¼	0-4	white/black-red	184
G ¼	0-6	white/black-red	185
G ¼	0-10	white/black-red	186
G ¼	0-16	white/black-red	187
G ¼	0-25	white/black-red	188
G ¼	0-40	white/black-red	189
G ¼	0-60	white/black-red	223



186

Vertical connection

G ¼	0-2.5	white/black-red	193
G ¼	0-4	white/black-red	194
G ¼	0-6	white/black-red	195
G ¼	0-10	white/black-red	196
G ¼	0-16	white/black-red	197
G ¼	0-25	white/black-red	198
G ¼	0-40	white/black-red	199



196

Pressure gauges Ø 63, industrial pressure gauges Ø 100, accessories



208



133



221



290



203



205



480-71



E61044

Pressure gauges Ø 63, calibratable

Graduation marks 0.1 bar. Display in bar and psi. With brass thread. Plastic disc, housing ABS black or steel housing. (Order No. 279). Tmax 60 °C. Display accuracy 86/217 EWG.

Thread	Display range (bar)	Calibration	Ground/Printing	Order No.
Horizontal connection				
G ¼	0–10	calibratable	black/white	208
G ¼	0–10	not calibratable	black/white	279

Bourdon tube industrial pressure gauges Ø 100

EN 837-1. For use in machine and plant construction. Provides high measuring accuracy under harsh operating conditions. Display in bar. With brass thread. Instrument glass pane. Robust bayonet ring housing made of 304 stainless steel with pressure relief opening. Suitable for gaseous and liquid media which do not attack copper alloys. Not suitable for acetylene, oxygen, high viscosity and crystallizing media. Protection IP 54 (EN 60529). Class 1. Tmax 60 °C. AF 22.

Thread	Display range (bar)	Ground/Printing	Order No.
Vertical connection			
G ½	0–2.5	white/black	130
G ½	0–4	white/black	131
G ½	0–6	white/black	132
G ½	0–10	white/black	133
G ½	0–16	white/black	134
G ½	0–25	white/black	135
G ½	0–40	white/black	136

Pressure gauges for bottled gases Ø 63

Safety pressure gauge according to ISO 5171 (in the past DIN EN 562). Display in bar. With brass thread. Plastic disc, steel housing with pressure release opening at rear. Class 2.5. Tmax 60 °C. Available with bar or litre scale. Bar scale additionally available as variant with inscription for gas type. With red marking.

Thread	Labeling	Display range (bar)	Red mark (bar)	Ground/Printing	Order No.
Vertical connection, bar scale					
G ¼	Acetylene	0–2.5	1.5	white/black-red	221
G ¼	Acetylene	0–40	26	white/black-red	314
G ¼	Oxygen	0–16	10	white/black-red	291
G ¼	Oxygen	0–40	20	white/black-red	321
G ¼	Oxygen	0–315	200	white/black-red	341
G ¼	–	0–2.5	1.5	white/black-red	222
G ¼	–	0–6	4	white/black-red	234
G ¼	–	0–16	10	white/black-red	290
G ¼	–	0–40	20	white/black-red	320
G ¼	–	0–100	50	white/black-red	330
G ¼	–	0–315	200	white/black-red	340
G ¼	–	0–315	230	white/black-red	206
G ¼	–	0–400	300	white/black-red	368

Thread	Display range (l/min)		Ground/Printing	Order No.
	Inner scale (red)	Outer scale		
Vertical connection, litre scale				
G ¼	0–16	0–32	white/black-red	203
G ¼	0–32 (for Argon)	0–30 (for CO ₂)	white/black-red/green/blue	205

Accessories for pressure gauges

Articles	Version	Order No.
Sealing disc PA natural	captive disc G ¼	480-71
Sealing ring aluminium	G ¼	E61044